

5" Lift and Lock 19" Assembly c:scape Mount

Installation Instructions 17814501 Rev B

D519MRGG24CS
D519MLGG24CS
D519MRGG30CS
D519MLGG30CS

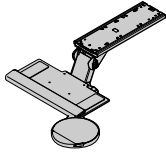

Tools required:

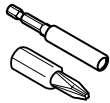

#2 Phillips
Screwdriver



Power Drill

- 1 When mounting right of center, the track needs to be mounted 1-1/2" away from the side of the center cover and the handle will need to shift and be re-mounted 2-1/2" towards the center. Install eight (8) 5/8" long wood screws through the track and attached directly to the bottomside of the worksurface.

When mounting left of center, the track can be mounted anywhere between the two (2) covers.

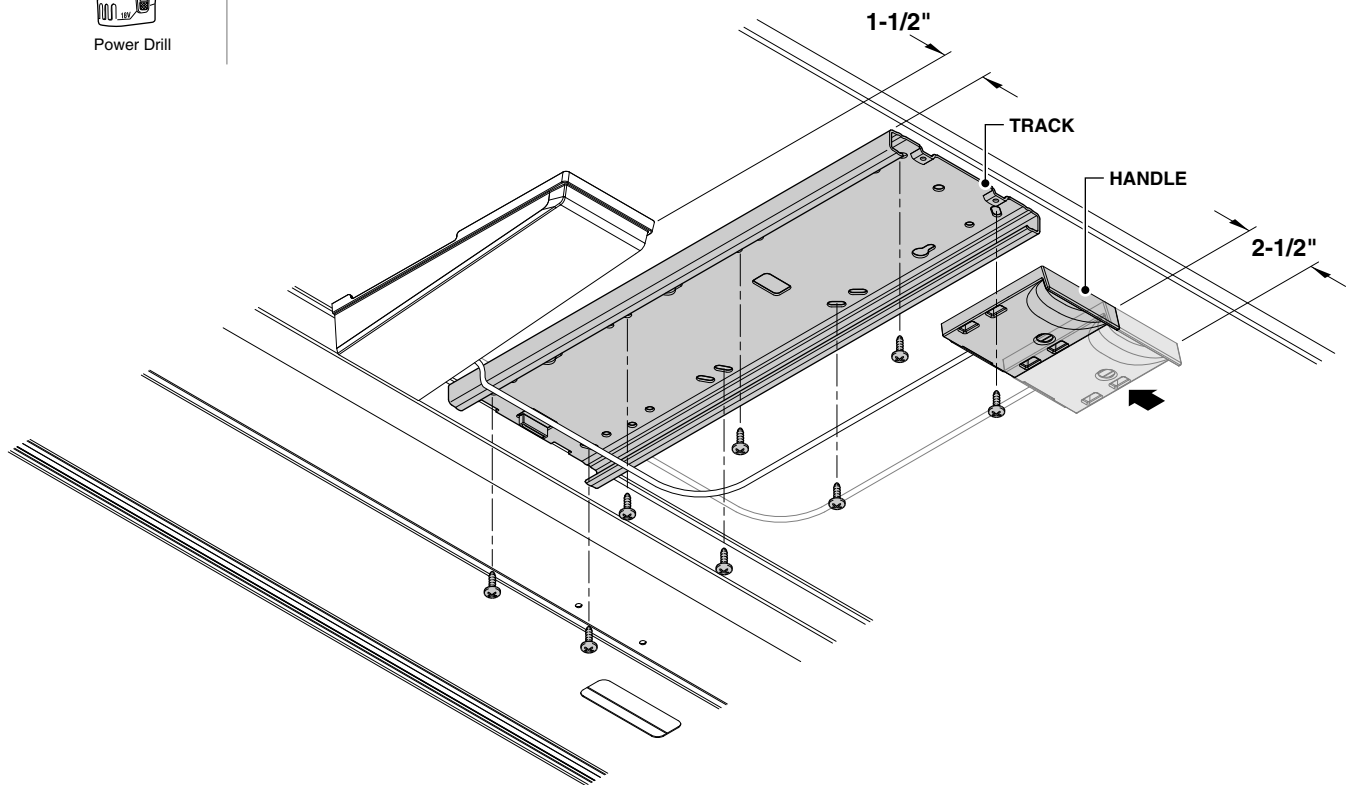

17814501 Rev B

- 2 Slide keyboard platform assembly into track.
- 3 Align track end cap with end of track.
- 4 Attach using two (2) screws.

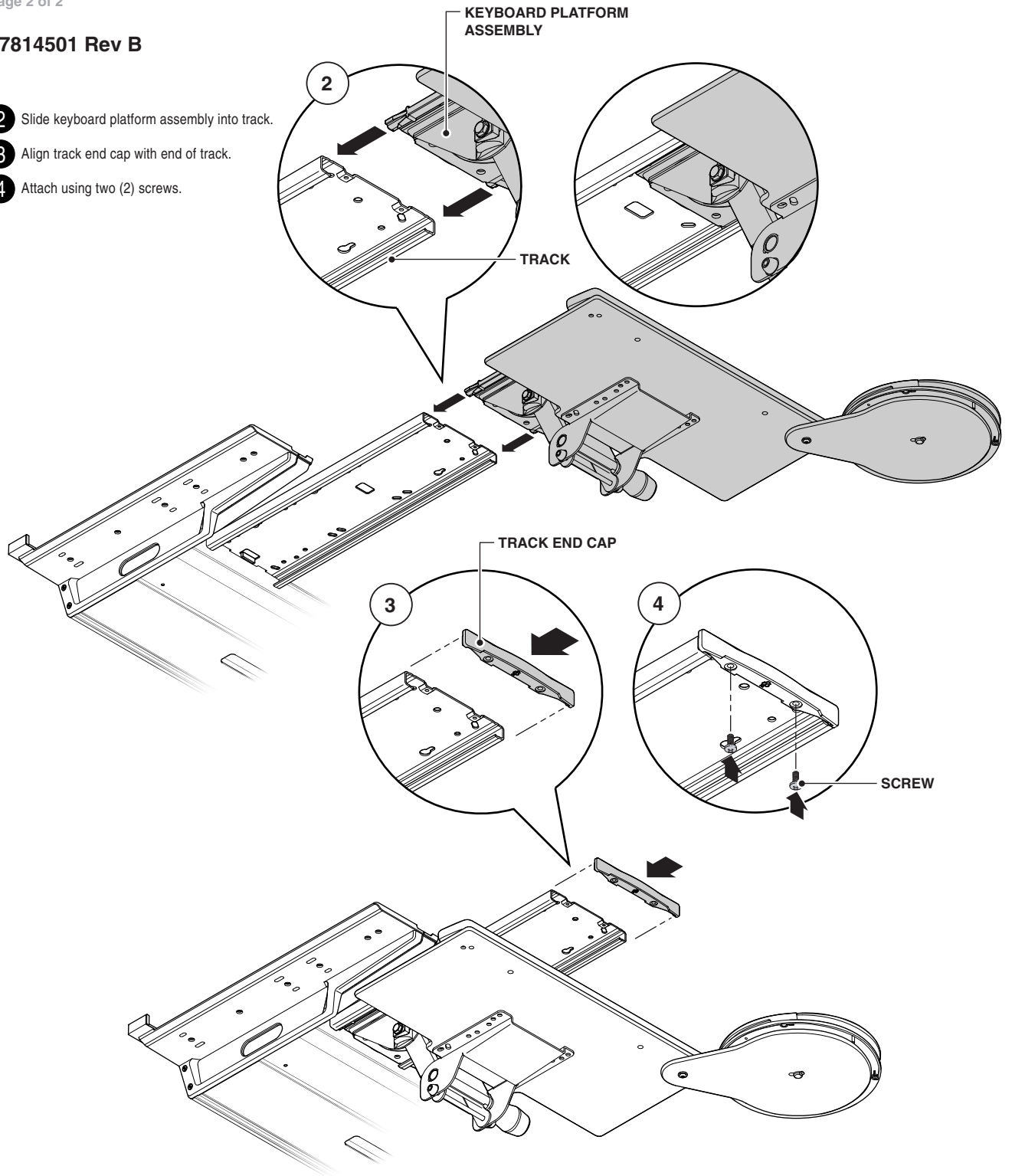

For further information, please go to the Details website details-worktools.com or call 800.833.0411

P.O. Box 1967 / CD-5E Grand Rapids, MI 49501-1967

©2010 Steelcase Inc. All rights reserved. 12/10