

Eyesite™ 1-Over-1 Monitor Mount

Installation Instructions 20488201 Rev C

FPAS101CC
 FPAS101TM
 FPAS101CS
 FPAS101FO

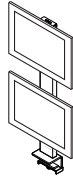

Tools required:

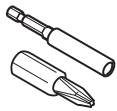

#2 Phillips



Power Drill



3/8" Dia. Drill Bit
 (through mount only)

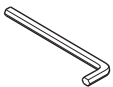

5/32" Allen Wrench
 (provided)

3/16" Allen Wrench
 (not provided) (C-clamp only)

1/16" Allen Wrench
 (not provided)

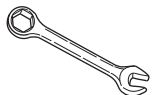

(through mount only)

- 1 Remove column cap from top of column (1a). Remove the supplied Allen wrench (1b). The first step in the installation is to install the column to the worksurface using the appropriate bracket for your application.

For a:

- Clamp mount scenario, see page 2.
- Through mount scenario, see page 2.
- C-clamp mount scenario, see page 3.
- FrameOne mount scenario, see page 4.

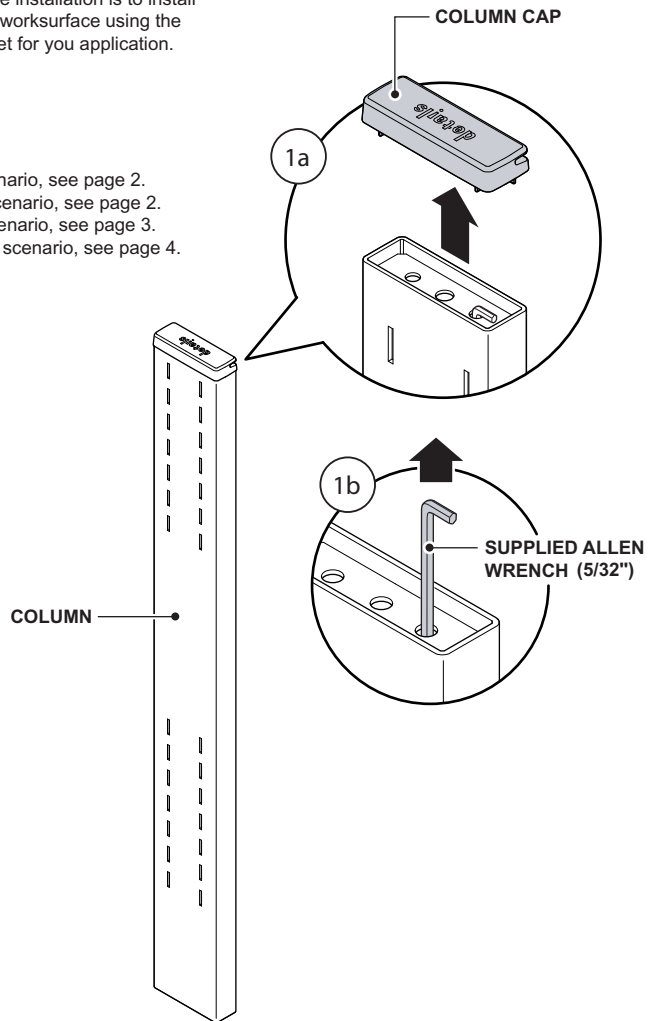

20488201 Rev C

Clamp Mount Installation

- 2 Locate the column on the center-line, directly opposite of the users intended work position (active zone) (2a).

Install the bottom bracket with the 2-3/16" Allen head screws provided (2b).

Install the 1/4" Allen head bolt in the bottom bracket (2c).

Insert the crush plate and secure the 1/4" Allen head bolt tightly to the worksurface (2d).

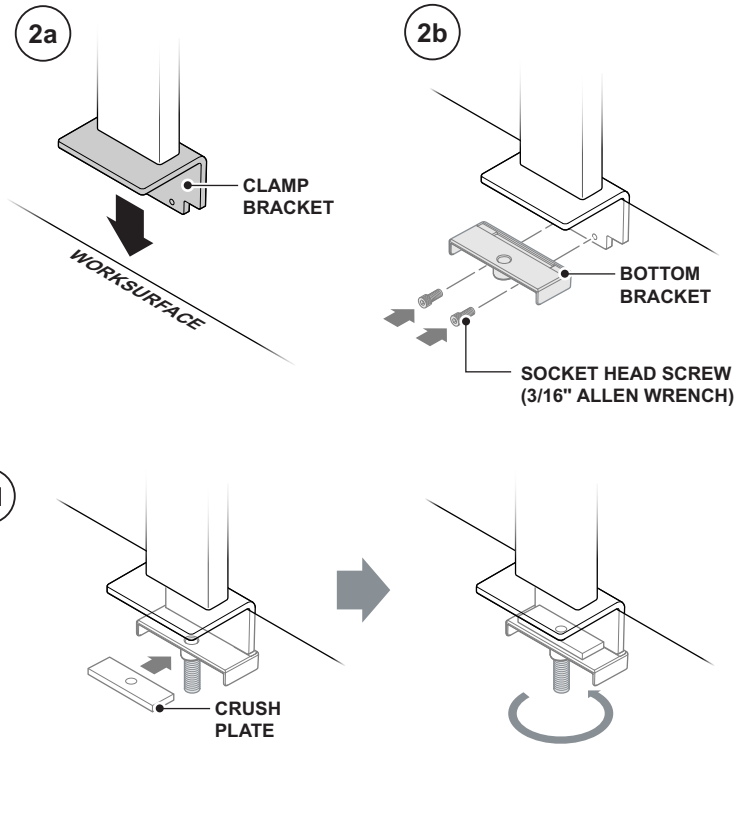

Through Mount Installation

- 2 Determine where you want your bracket placed and drill a hole using a 3/8" dia. drill bit (2a).

NOTE: In corner applications, we recommend drilling the hole 24" from the front edge of the worksurface on the center-line of the users intended work position (active zone).

Attach through mount bracket to underside of column using two (2) screws (2b) (provided).

Place assembled through mount bracket and column onto worksurface making sure carriage bolt is inserted through drilled hole (2c).

Assemble plate and nut to carriage bolt underneath the worksurface (2d).

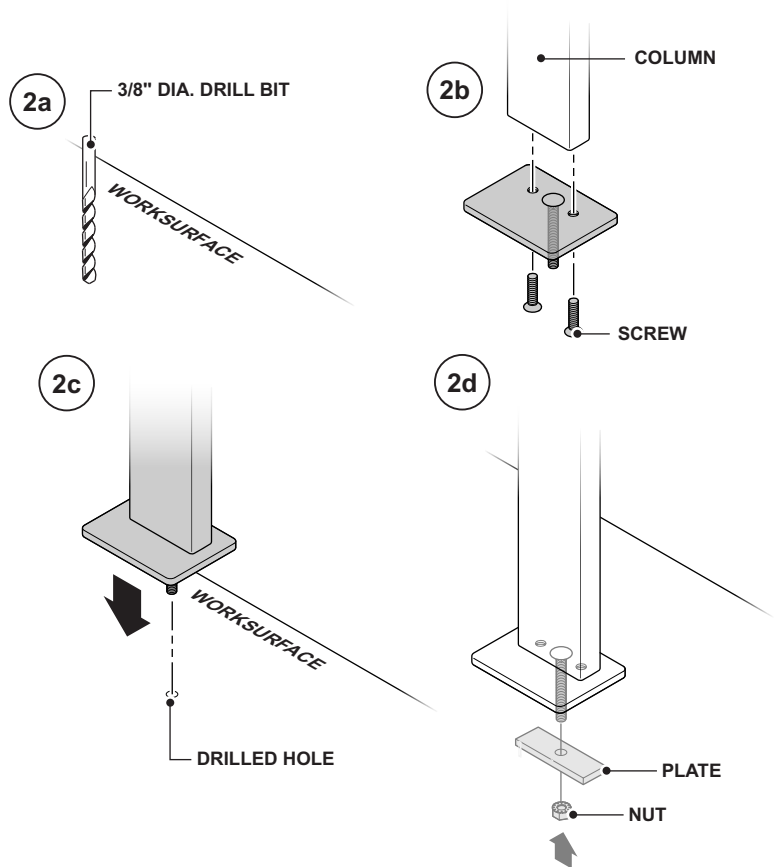

20488201 Rev C

c:scape Mount Installation

2 Mount screws and t-nuts in the correct orientation as shown (2a) (refer to table on bottom of bracket).

Slide clamping bracket into bottom of base bracket (note tab direction, per side view) (2b).

Secure clamping bracket and spacer to base bracket using two (2) screws, but attach loosely (2c).

Lower bracket and column assembly onto rail at rear of c:scape desk (2d). Align two (2) t-nuts with rail slot to aid installation. Tighten t-nut fasteners that were installed in step 2c.

Guide brace into place, beneath worksurface. Install two (2) screws (2e).

Install plastic cover by sliding it over the top of the base bracket (2f).

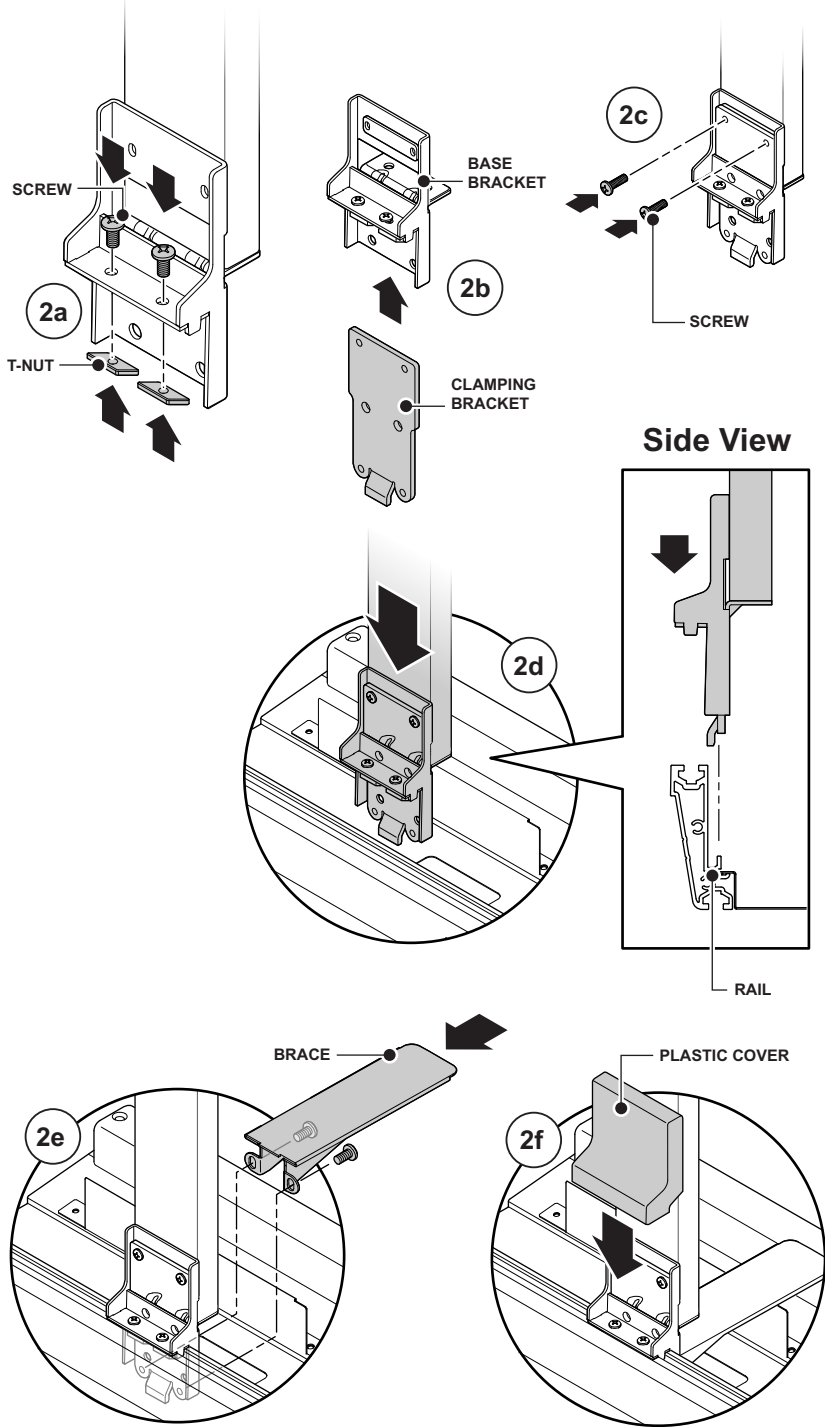

20488201 Rev C

FrameOne Mount Installation

- 2 Mount base plate to column assembly with flathead screws (2a).

Mount flathead screws and t-nuts to the base plate (2b).

Lower column assembly onto the FrameOne center beam, making sure the t-nuts are in the correct orientation as shown (2c).

Tighten all four (4) flathead screws with t-nuts, making sure that the t-nuts rotate into position as shown.

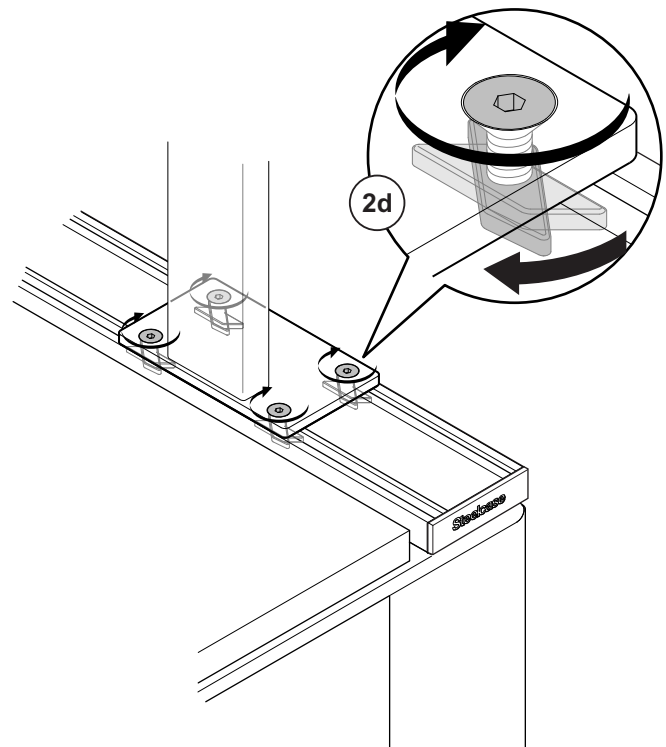
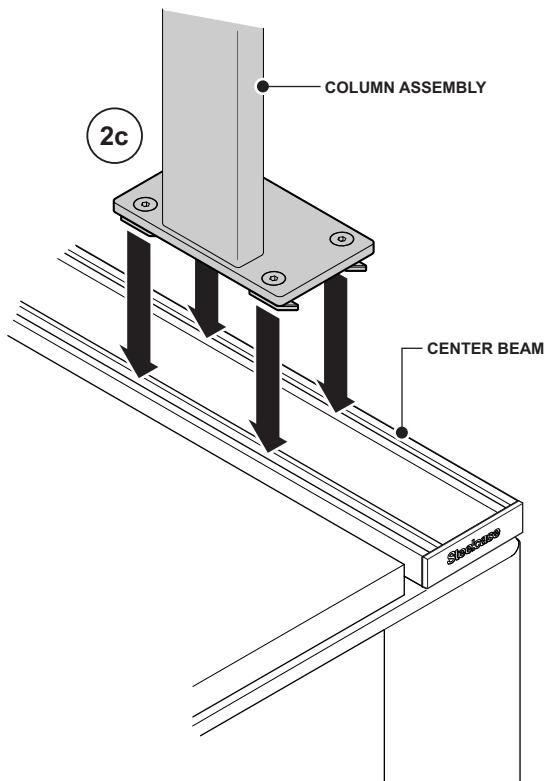
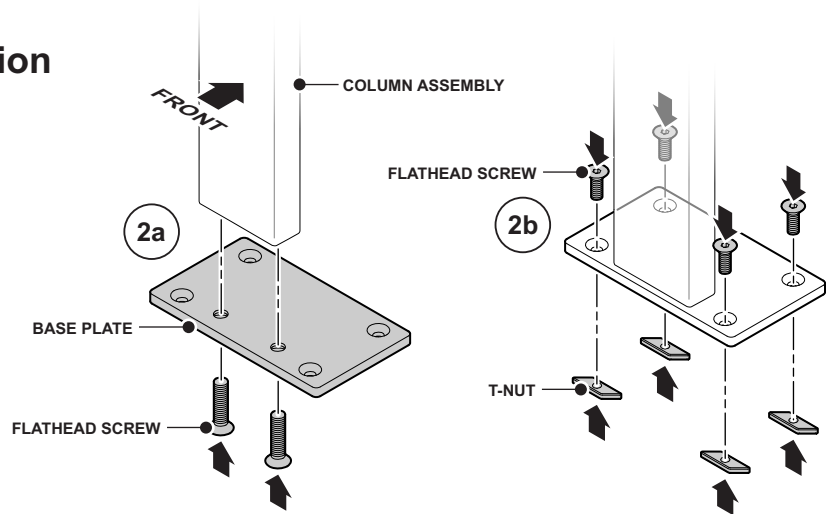

20488201 Rev C

- 3** Install the lower monitor first ensuring the desired clearance from the worksurface. Next, install the second monitor ensuring a 10° gap to allow for tilt of the upper monitor. Align teeth of monitor mount bracket assembly with slots located in the column (3a).

Angle the teeth into the slots (3b) and swing monitor mount bracket assembly inward (3c). With teeth engaged into slots, press downward onto the monitor mount bracket assembly (3d).

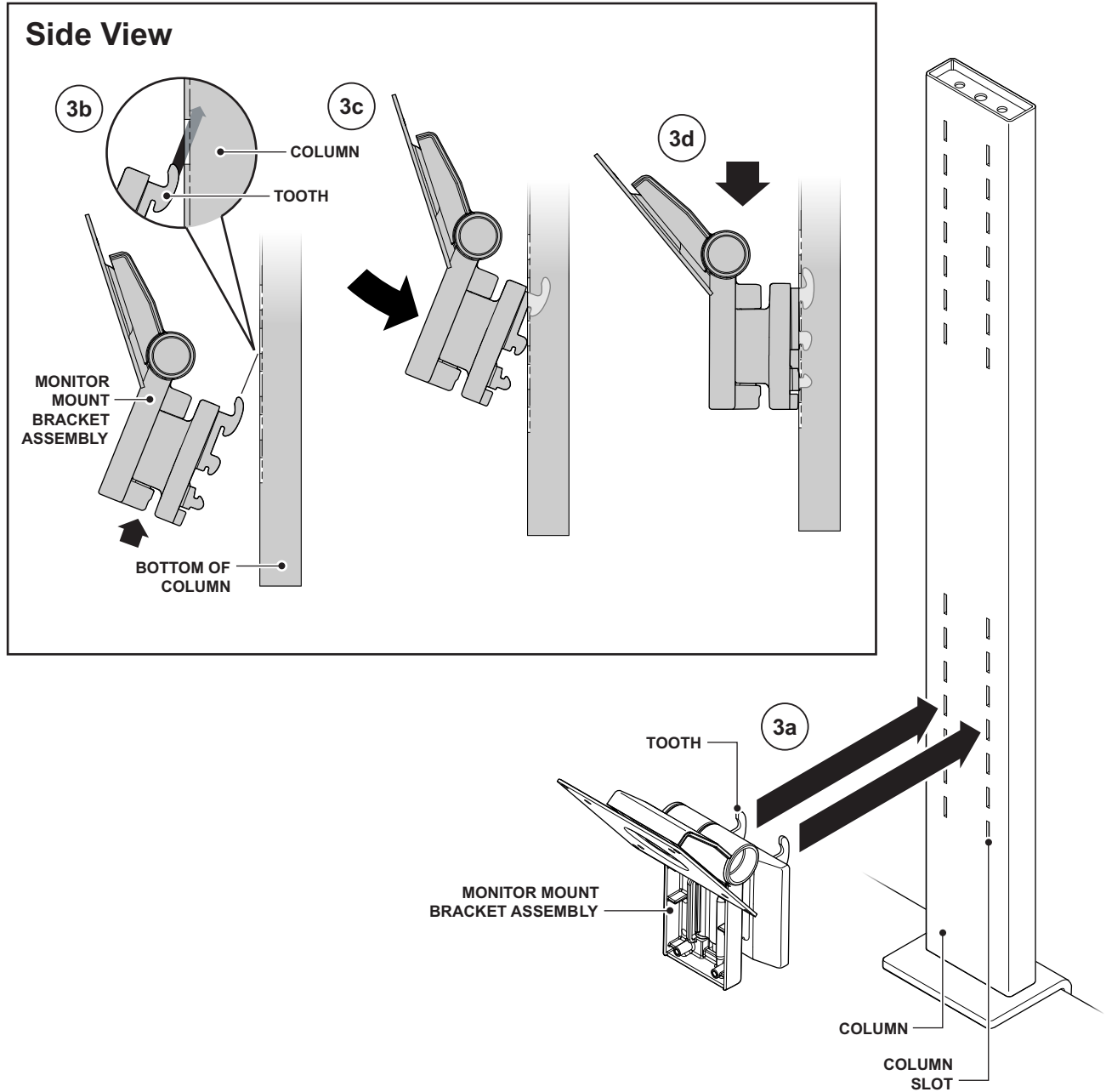

20488201 Rev C

4 Locate the locking screw under the monitor mount bracket assembly and tighten using the "ball end" of the supplied Allen wrench (4a). As you tighten the locking screw, the tooth of the monitor mount bracket assembly will begin to move upward inside the column (4b) and tighten against the wall of the column (4c) locking the monitor mount bracket

5 The monitor tilt can be adjusted by tilting the monitor forward or backward to eliminate glare. To adjust tension, adjust via the supplied Allen wrench via the feather touch counter balance screw. Locate set screw on the monitor mount bracket assembly and loosen or tighten by turning with the supplied Allen wrench (5a). Pivot the monitor mount assembly toward the column (5b).

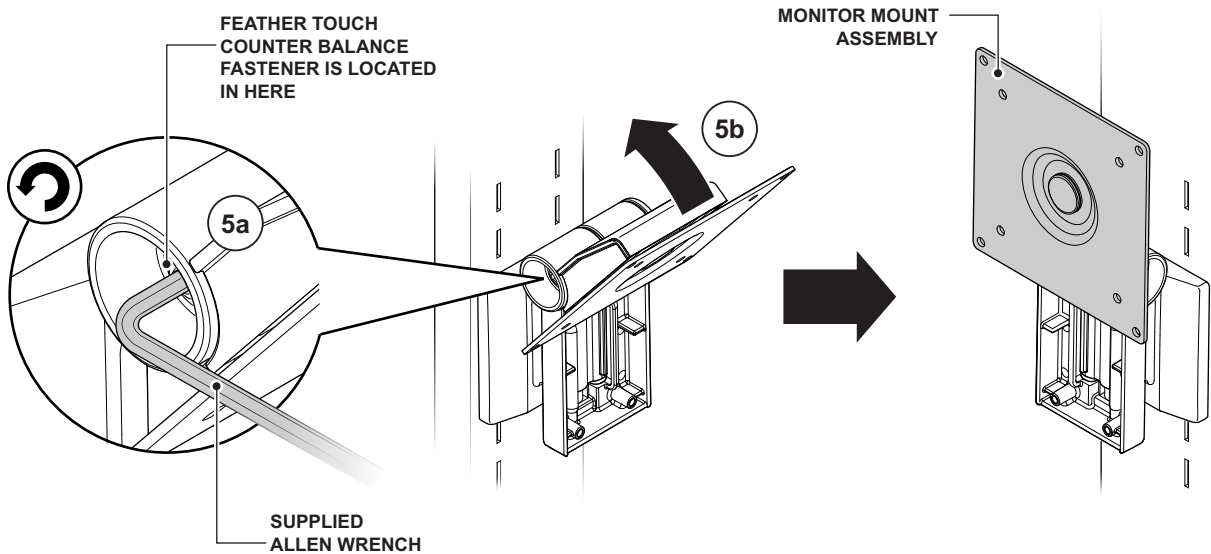
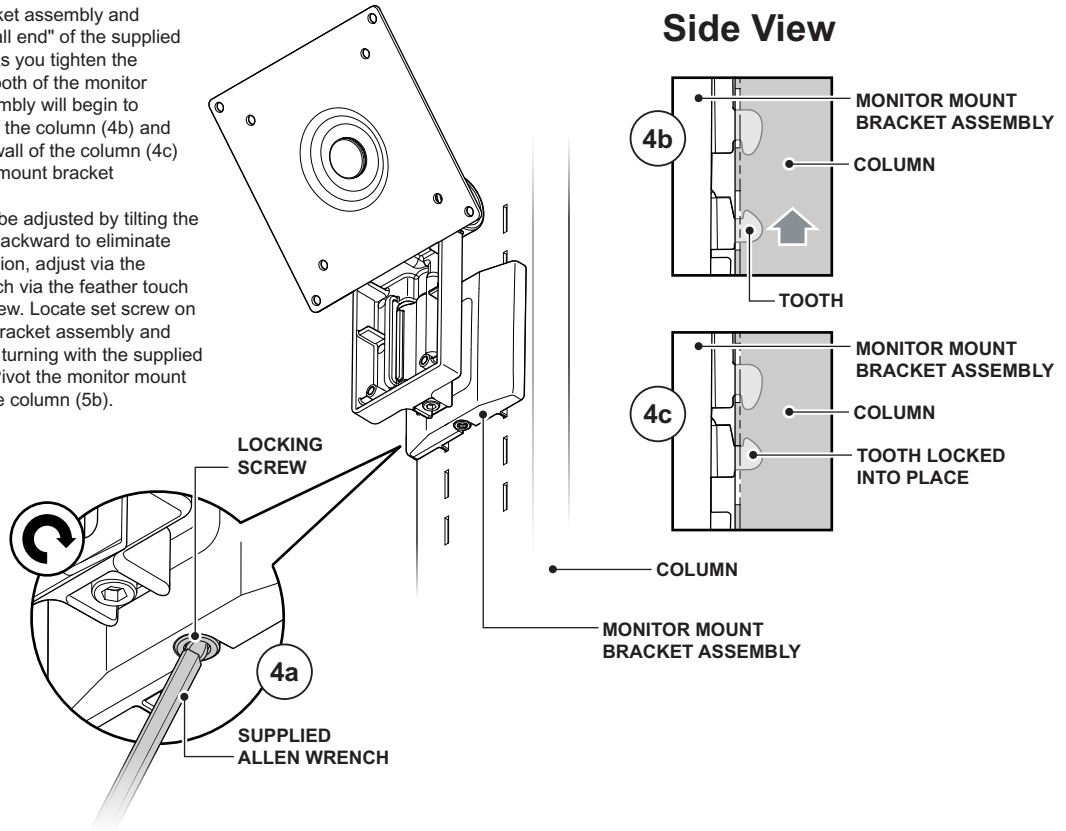

20488201 Rev C

- 6 Place monitor mount assembly onto the back of monitor (6a) and secure using four (4) screws. The holes to be used are determined by the monitor choice (6b). Use the outer four (4) holes for 100 mm and the inner four (4) holes for 75mm (6b).

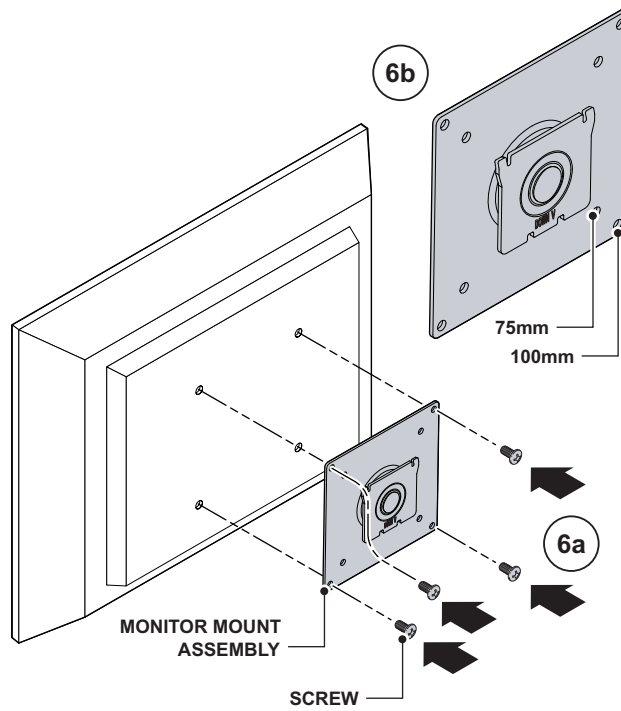

20488201 Rev C

- 7** Slide monitor mount assembly back into the monitor mount bracket assembly (7a). Take note of the embossed alignment arrow located on the monitor mount assembly. This should be pointed downward (7b).
- 8** To secure each monitor mount, you must first locate the set screw and turn to the right to tighten using an Allen wrench (8a).
Close each monitor mount bracket assembly cover (8b).

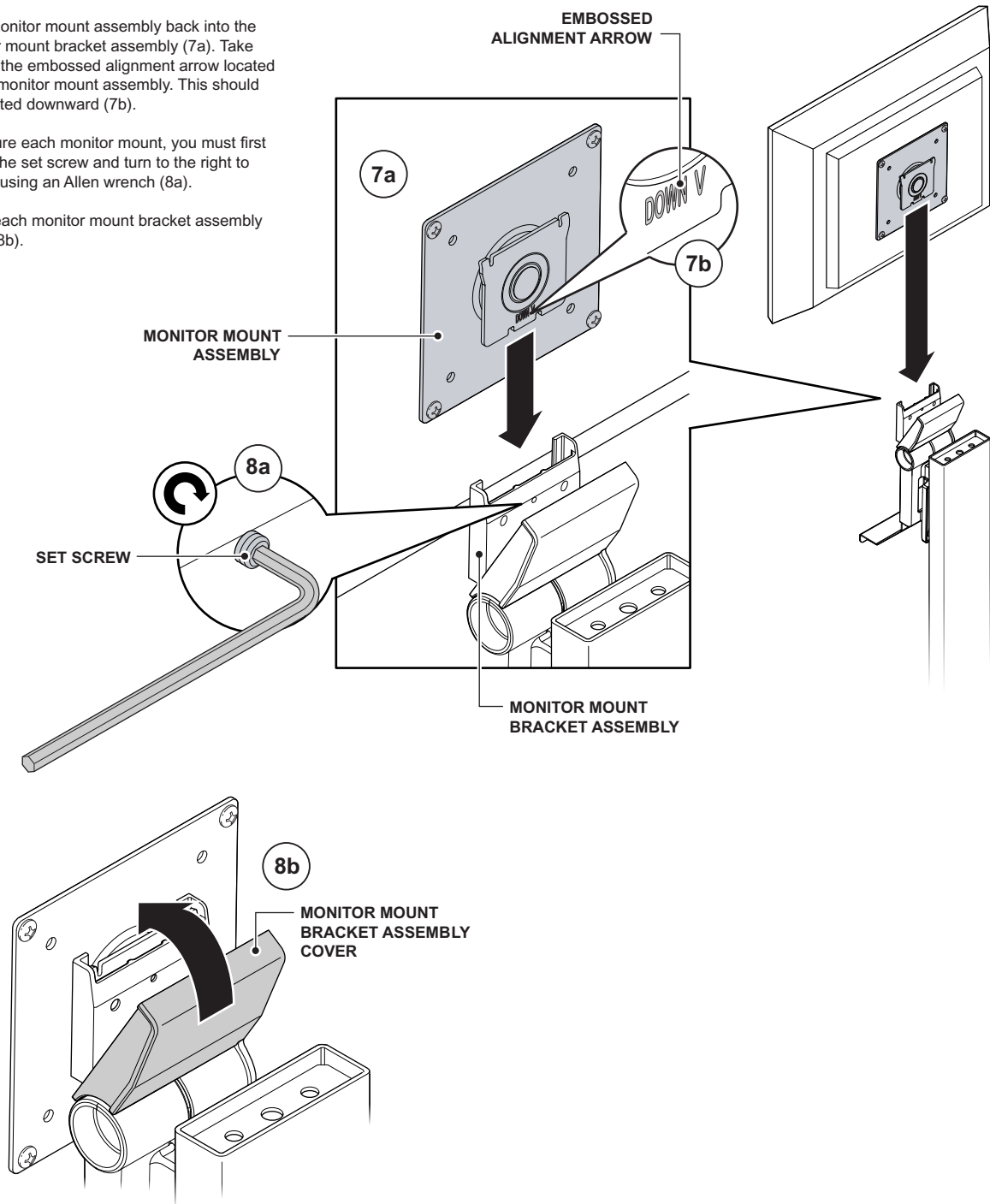

For further information, please go to the Details website details-worktools.com or call 800.833.0411

P.O. Box 1967 / CD-5E Grand Rapids, MI 49501-1967

©2011 Steelcase Inc. All rights reserved. 1/11