

FYI™ Mounting Hardware for Sync

Customer Needs:

Facilitate the addition of FYI monitor support arms onto Sync at the top of leg into one or both port locations.

User Requirements:

- Enables the addition of additional monitor support arm(s) to meet changing technology needs after initial installation.
- Ensures proper installation of FYI support arms onto Sync.
- Provides appropriate covers for unused monitor support ports if monitor support arm is removed.

Product Features

Style Numbers:

FPASYNM – to mount FYI Flat Panel Arms to Sync

- Size:
 - Cap – Leg, Blank 4¼" x 2¼" x ½"
 - Cap – Monitor Mount, Single 3" x 2¼" x ½"
 - Cap – Monitor Mount, Double 3" x 2¼" x ½"
 - Cap – Monitor Mount, End 1¼" x 2¼" x 7/16"
 - Plate – Bottom, Monitor Mt 3-7/8" x 2" x ⅛"
 - Spacer – Monitor Mt 3⅝" x 1½" x 1-5/16"
- Weight: .75 lbs
- Colors:
 - Platinum (caps)
 - Black (plates and spacer)
- Construction:
 - Nylon (caps)
 - Steel (plates)
 - Engineering resin (spacer)
- Warranty: 10 years
- Package includes necessary fasteners (not shown).

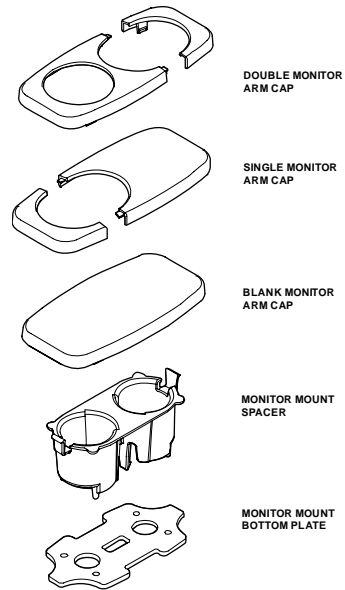

For further information, please go to the Details website details-worktools.com or call 800.833.0411

P.O. Box 1967 / CD-5E Grand Rapids, MI 49501-1967
©2010 Steelcase Inc. All rights reserved. 5/10