

I/Q Mechanisms

Installation Instructions

005409D Rev C Page 1 of 1

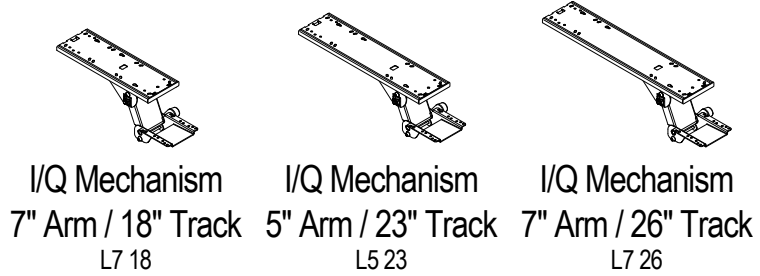

I/Q Mechanisms Installation Instructions

1 Please make use of all appropriate hardware provided. Retain two (2) screws for attachment of front cap. Mounting screws are 1" in length. When attaching track to a worksurface with a 1" thickness or less, please source appropriate length screws locally.

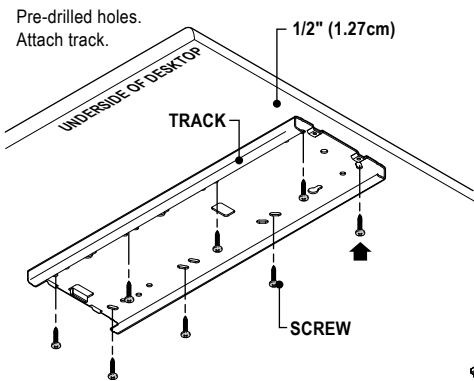

NOTE: Orient track so holes align with channels on Series 9000 top.

2 Slide mechanism into track.

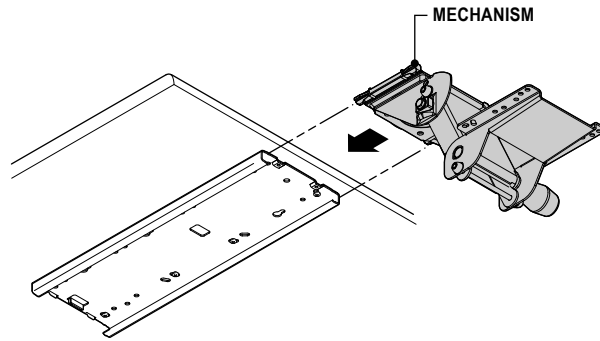

3 Insert end cap.

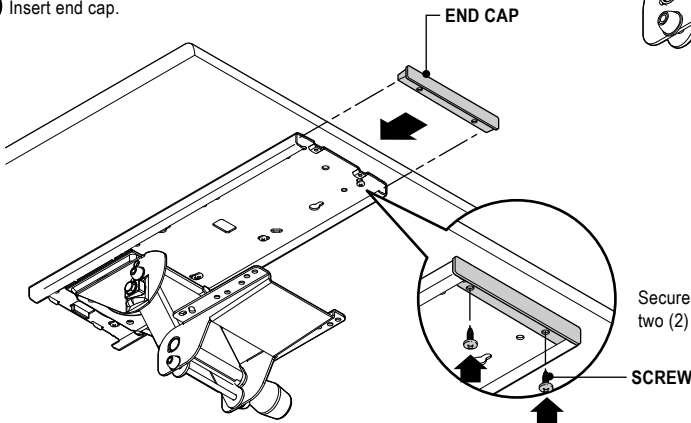

Attach keyboard platform to mechanism using the nuts provided.

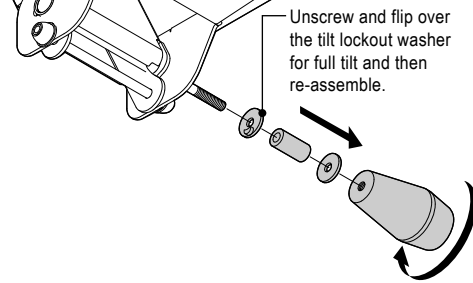

Secure front cap with the two (2) machine screws provided.

For a better day at work.™

details®

A STEELCASE COMPANY

P.O. Box 1967 / CD-5E / Grand Rapids, MI 49501-1967 / www.details-worktools.com

©2007 Office Details Inc. All rights reserved. Printed in U.S.A. 8/07

www.details-worktools.com

details®