

Galilei™ Mini & Passive Laptop Shelves

Installation Instructions 001810 Rev C

KMINI

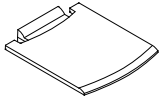

KLPS

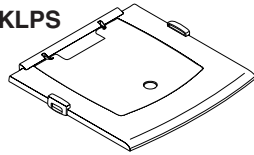

Mini Shelf

Select a spot on the Slatwall to mount the Mini Shelf.

Make sure that the Slatwall interface is fully engaged with the Slatwall.

Maximum Weight = 5 lbs.

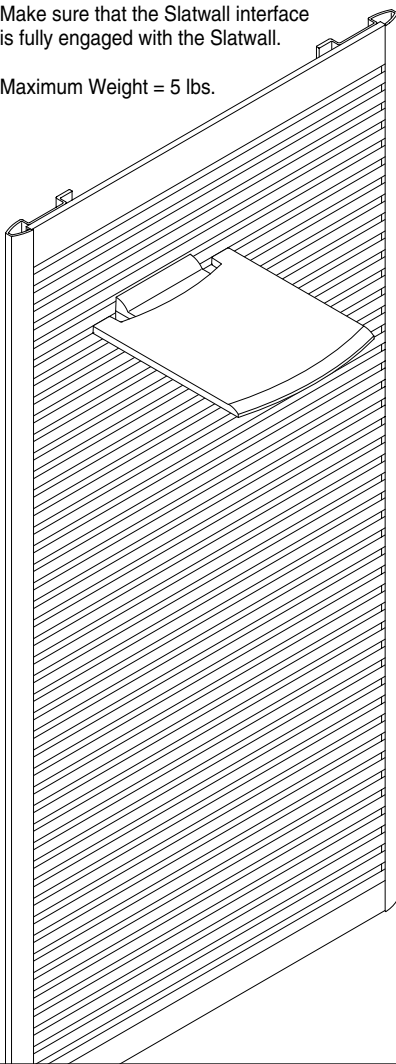

Passive Laptop Shelf

Remove the two sliding keepers from inside the shelf pan. Slide keepers into grooves on shelf.

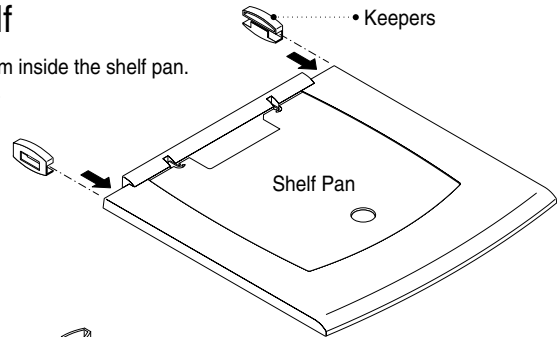

Select a spot on the Slatwall to mount the shelf. For seated use, mount at worksurface height (~29"). Standing use will depend on height of the user.

Attach shelf to Slatwall. Make sure that the Slatwall interface is fully engaged with the Slatwall.

Push the two anti-dislodgement tabs into Slatwall, there will be a "click" when engaged.

To remove the shelf, pull towards you on the two anti-dislodgement tabs.

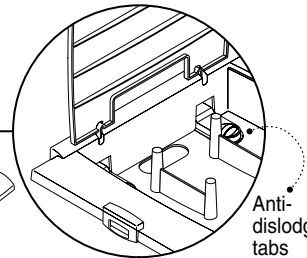
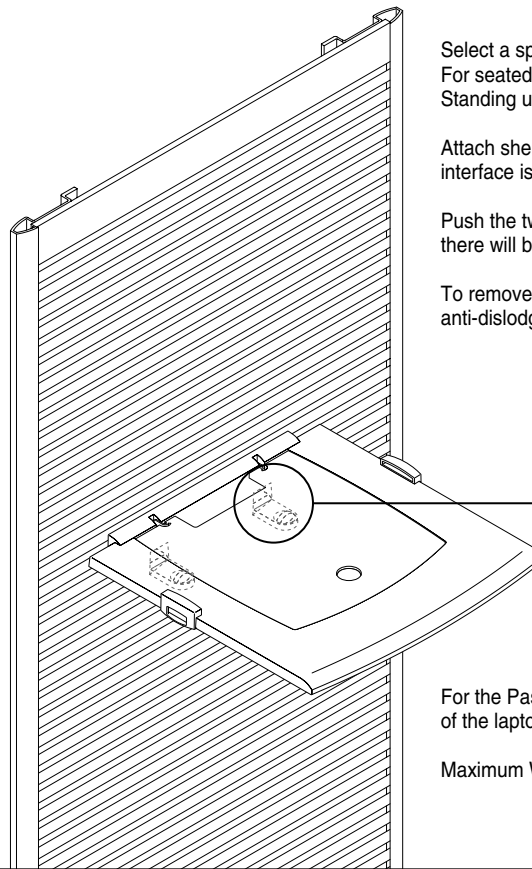

For the Passive Shelf over a worksurface, the top of the laptop screen should be just below eye level.

Maximum Weight = 20 lbs.

For further information, please go to the Details website details-worktools.com or call 800.833.0411

P.O. Box 1967 / CD-5E Grand Rapids, MI 49501-1967

©2010 Steelcase Inc. All rights reserved. 10/10