

AdjusTables Series 7 Troubleshooting Guide

Issues with Table or Primary Cause of Faulty Operation	Suggested Fixes
No Power	<ol style="list-style-type: none"> 1) Check Power Source <ul style="list-style-type: none"> • Are panels powered? • Is Control Box plugged into powered AC outlet?
Table doesn't move although power is on	<ol style="list-style-type: none"> 1) Check to see that cables are fully seated from the control box to the outlet, the up/down controller to the control box, and the control box to each leg. 2) If still not working, replace control box with known working control box. 3) If still not working, replace up/down controller with working up/down controller. 4) If still not functional, replace cables with working cables. 5) If still not functional, test each leg independently <ul style="list-style-type: none"> • Remove power from control box • Unplug all legs • Plug each leg in sequence to the port furthest from the AC power-in • Check operation – DO NOT allow to travel excessive distance or the stretcher(s) will become distorted. • Replace any leg found to be defective and run operational test again.
Unbalanced legs	<ol style="list-style-type: none"> 1) First, check to be certain that the glides are adjusted properly. 2) Next, lower table and then synchronize table (hold down arrow for 5 secs).
Improper wiring	<ol style="list-style-type: none"> 1) Insure plugs are correctly and fully inserted (refer to installation instructions)
Bad Controller switch	<ol style="list-style-type: none"> 1) Test with different controller. Replace if necessary
Bad Leg	<ol style="list-style-type: none"> 1) Test with different leg. Replace if necessary
Bad Cable	<ol style="list-style-type: none"> 1) Check cable for obvious pinch points or abrasions. Retest table with different cable.

AdjustTables Series 7 Troubleshooting Guide

S7 - STRAIGHT 23W

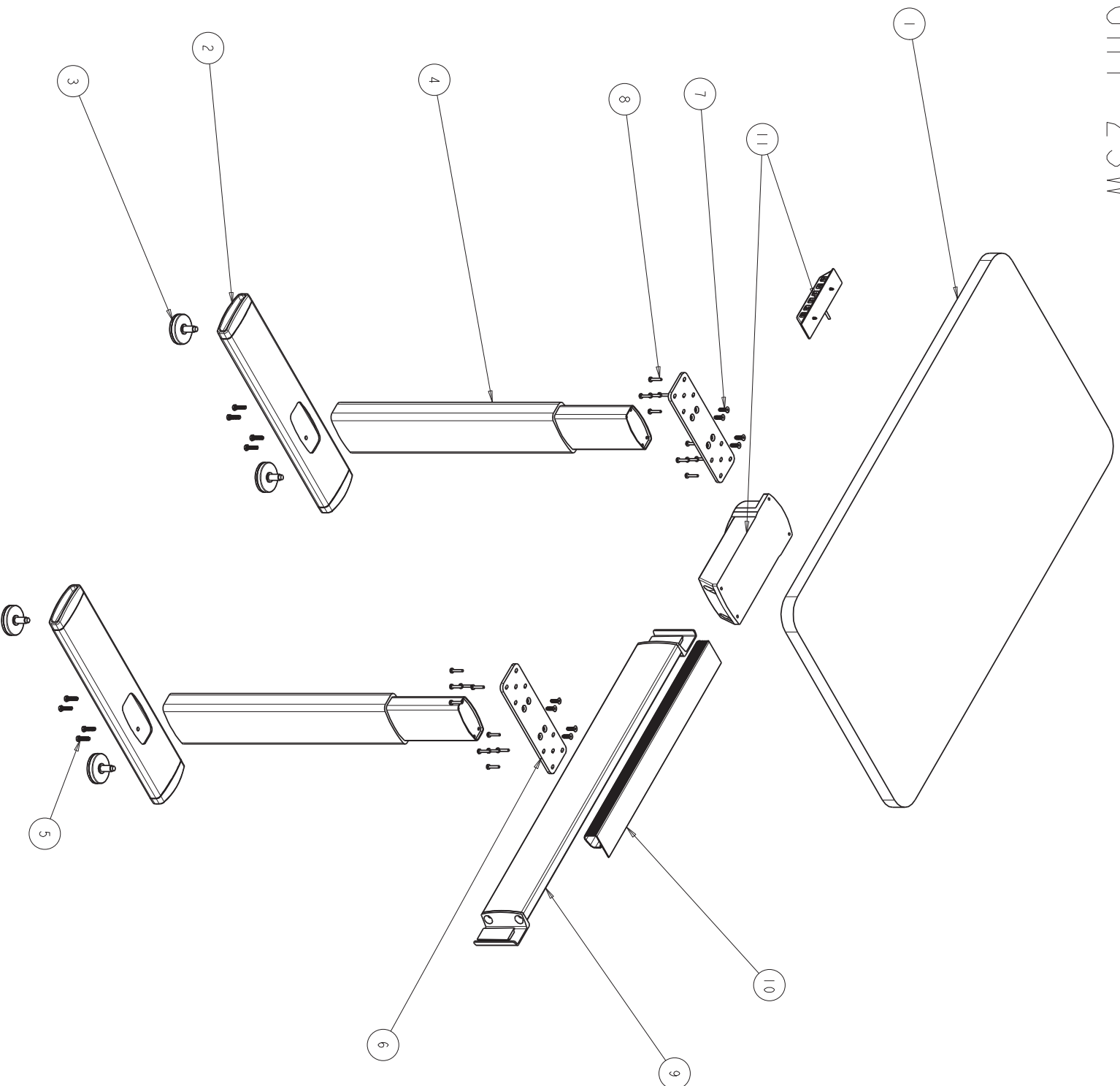

S.no	Part Number	Description
1	S7	RECTANGULAR WORKSURFACE - 23W
2	004838D	FOOT W/ ENDCAPS ASSY, 19
3	002872D	GLIDE - LEVELLING, 2.125 OD
4	003072D	LIFTING COLUMN W/ MOUNTING BRACKET
5	003110D	SCREW-CAP, BINHD, HEX SOC, M6-1.0 X 20
6	003959D	MOUNTING PLATE - LEG
7	003754D	M6-1.0 X 20 FLAT HD SOCKET HD CAP SCREW
8	003755D	#10 X 1 PHILLIPS PAN HD PARTICLE BD SCREW
9	SEE NOTE 1	STRETCHER SUB-ASSEMBLY STRAIGHT
10	005101D	WIRE MANAGER, 22
11	SEE NOTE 2	WORKSURFACE CONTROL KIT - 2 LEG

NOTES:

1. THE FOLLOWING STRETCHER SIZES CAN BE USED DEPENDING ON THE LENGTH OF THE WORKSURFACE.

26.25	IN	-	004858D
30.25	IN	-	004859D
33.75	IN	-	004860D
37.75	IN	-	004861D
47	IN	-	004862D
51.50	IN	-	004863D
60	IN	-	005294D
70	IN	-	005295D

2. ONE OF THE FOLLOWING WORKSURFACE CONTROL KITS CAN BE USED.

003764D	-	WORKSURFACE CONTROL KIT - 2 LEG
004998D	-	WORKSURFACE (ADJ) CONTROL KIT - 2 LEG
005292D	-	WORKSURFACE DIGITAL CONTROL KIT - 2 LEG

AdjustTables Series 7 Troubleshooting Guide

S7 - STRAIGHT 29W

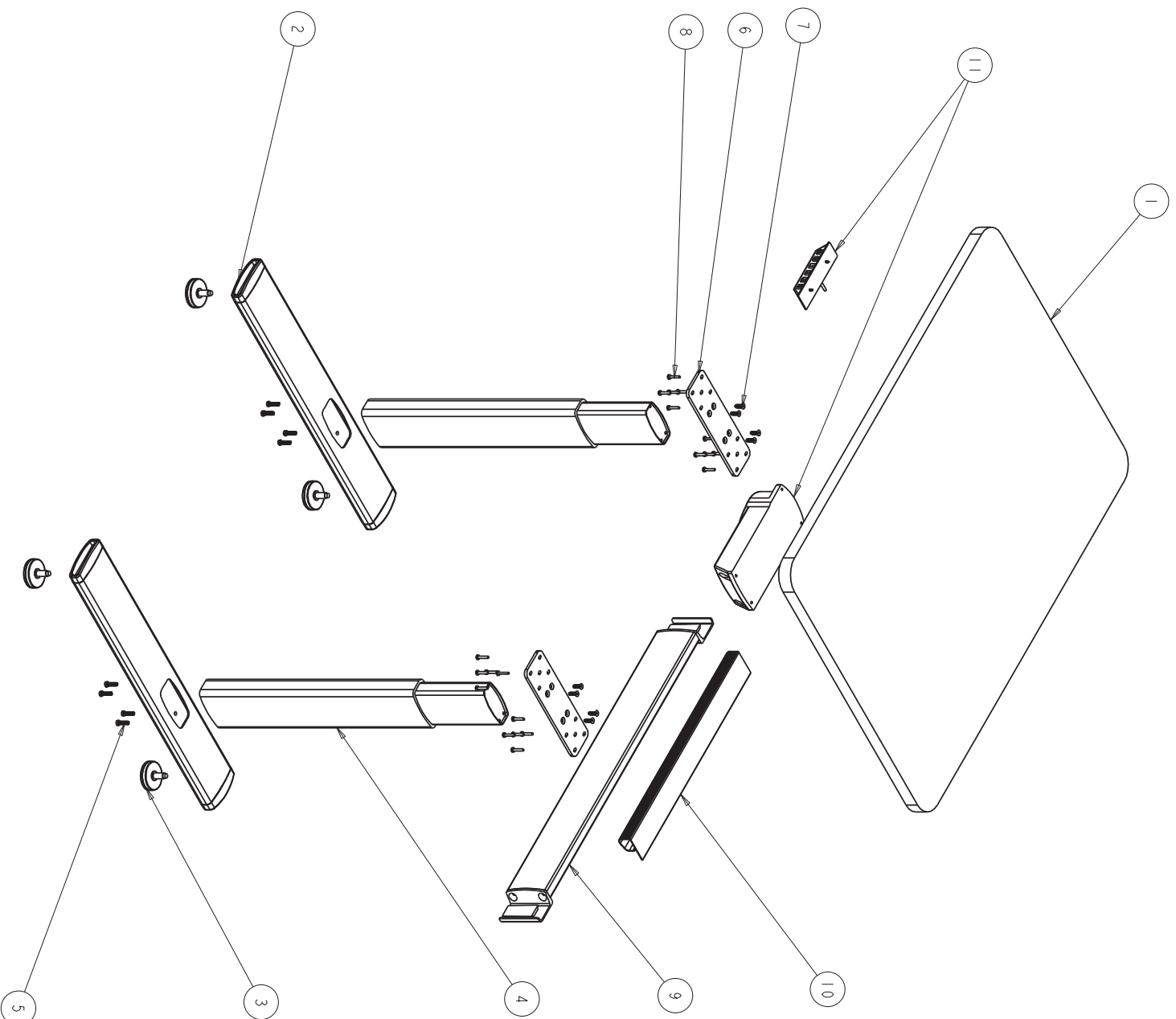

S.no	Part Number	Description
1	004837D	S7 - RECTANGULAR WORKSURFACE - 29W
2	002872D	FOOT W/ ENDCAPS ASSY, 26
3	003072D	GLIDE - LEVELLING, 2.125 OD
4	003110D	LIFTING COLUMN W/ MOUNTING BRACKET
5	003959D	SCREW-CAP, BTNHD, HEX SOC, M6-1.0 X 20
6	003754D	MOUNTING PLATE - LEG
7	003755D	M6-1.0 X 20 FLAT HD SOCKET HD CAP SCREW
8	SEE NOTE 1	#10 X 1 PHILLIPS PAN HD PARTICLE BD SCREW
9	005101D	STRETCHER SUB-ASSEMBLY STRAIGHT
10	SEE NOTE 2	WIRE MANAGER, 22
11	SEE NOTE 2	WORKSURFACE CONTROL KIT - 2 LEG

NOTES:

1. THE FOLLOWING STRETCHER SIZES CAN BE USED DEPENDING ON THE LENGTH OF THE WORKSURFACE.

- 26.25 IN - 004858D
- 30.25 IN - 004859D
- 33.75 IN - 004860D
- 37.75 IN - 004861D
- 47.50 IN - 004862D
- 51.50 IN - 004863D
- 60 IN - 005294D
- 70 IN - 005295D

2. ONE OF THE FOLLOWING WORKSURFACE CONTROL KITS CAN BE USED.

- 003764D - WORKSURFACE CONTROL KIT - 2 LEG
- 004998D - WORKSURFACE (ADJ) CONTROL KIT - 2 LEG
- 005292D - WORKSURFACE DIGITAL CONTROL KIT - 2 LEG.

SCALE 0.175

AdjustTables Series 7 Troubleshooting Guide

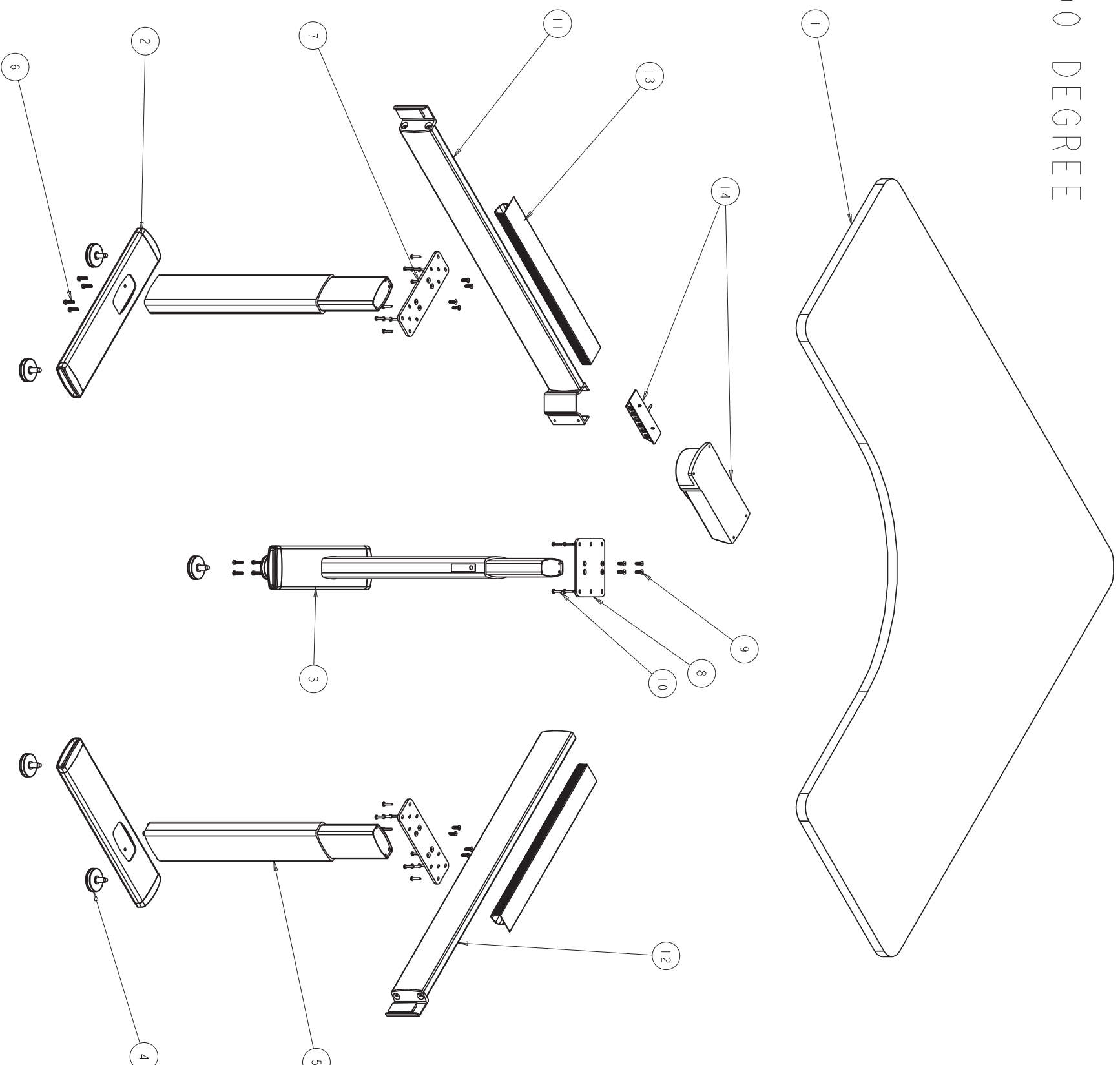

S.no	Part Number	Description
1		S7 - RECTANGULAR WORKSURFACE - 29W
2	SEE NOTE 1	FOOT W/ ENDCAPS ASSY
3	005254D	FOOT W/ ENDCAPS ASSY, 15.25 (CENTRE)
4	002872D	GLIDE - LEVELLING, 2.125 OD
5	003072D	LIFTING COLUMN W/ MOUNTING BRACKET
6	003110D	SCREW-CAP, BTMHD, HEX SOC, M6-1.0 X 20
7	003959D	MOUNTING PLATE - LEG
8	004832D	MOUNTING PLATE CENTRE
9	003754D	M6-1.0 X 20 FLAT HD SOCKET HD CAP SCREW
10	003755D	#10 X 1 PHILLIPS PAN HD PARTICLE BD SCREW
11	SEE NOTE 2	STRETCHER ASSEMBLY - 90 DEG, LH
12	SEE NOTE 3	STRETCHER ASSEMBLY - 120/90 DEG, RH
13	005101D	WIRE MANAGER, 22
14	SEE NOTE 4	WORKSURFACE CONTROL KIT - 3 LEG

NOTES:

1. FOR STRETCHER SIZE 26.25, 30.25, 33.75IN, 16IN FOOT IS USED.
 004839D - FOOT W/ ENDCAPS ASSY, 16.
 FOR OTHER STRETCHER SIZES 19IN FOOT IS USED.
 004838D - FOOT W/ ENDCAPS ASSY, 19.
 ITEM#3, 15.25IN FOOT WILL ALWAYS COME IN THE CENTRE.

2. THE FOLLOWING 90 DEG LH STRETCHER SIZES CAN BE USED DEPENDING ON THE LENGTH OF THE WORKSURFACE.

- 26.25 IN - 004872D
- 30.25 IN - 004873D
- 33.75 IN - 004874D
- 37.75 IN - 004875D
- 47 IN - 004876D
- 51.50 IN - 004877D
- 60 IN - 005300D
- 70 IN - 005301D
- 74 IN - 005302D

3. THE FOLLOWING 120/90 DEG RH STRETCHER SIZES CAN BE USED DEPENDING ON THE LENGTH OF THE WORKSURFACE.

- 26.25 IN - 004865D
- 30.25 IN - 004866D
- 33.75 IN - 004867D
- 37.75 IN - 004868D
- 47 IN - 004869D
- 51.50 IN - 004870D
- 60 IN - 005306D
- 70 IN - 005307D
- 74 IN - 005308D

4. ONE OF THE FOLLOWING WORKSURFACE CONTROL KITS CAN BE USED.

- 004846D - WORKSURFACE CONTROL KIT - 3 LEG
- 003765D - WORKSURFACE (ADJ) CONTROL KIT - 3 LEG
- 004999D - WORKSURFACE DIGITAL CONTROL KIT - 3 LEG.

AdjustTables Series 7 Troubleshooting Guide

S7 - 120 DEGREE

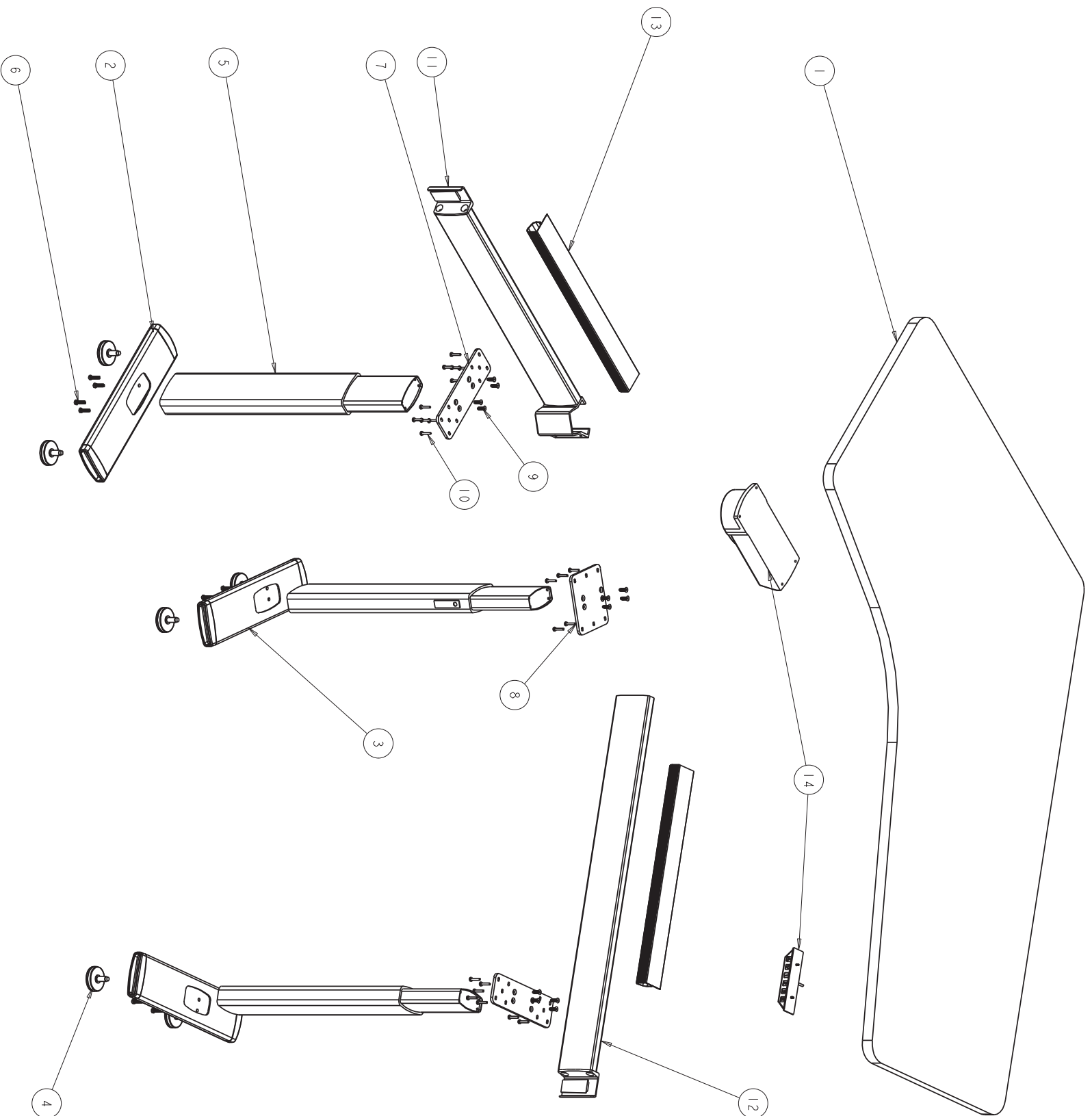

S.no	Part Number	Description
1	S7 - RECTANGULAR WORKSURFACE - 29W	
2	SEE NOTE 1	FOOT W/ ENDCAPS ASSY
3	005254D	FOOT W/ ENDCAPS ASSY, 15.25 (CENTRE)
4	002872D	GLIDE - LEVELLING, 2.125 OD
5	003072D	LIFTING COLUMN W/ MOUNTING BRACKET
6	003110D	SCREW-CAP, BTMHD, HEX SOC, M6-1.0 X 20
7	003959D	MOUNTING PLATE - LEG
8	004832D	MOUNTING PLATE CENTRE
9	003754D	M6-1.0 X 20 FLAT HD SOCKET HD CAP SCREW
10	003755D	#10 X 1 PHILLIPS PAN HD PARTICLE BD SCREW
11	SEE NOTE 2	STRETCHER ASSEMBLY - 120 DEG, LH
12	SEE NOTE 3	STRETCHER ASSEMBLY - 120/90 DEG, RH
13	005101D	WIRE MANAGER, 22
14	SEE NOTE 4	WORKSURFACE CONTROL KIT - 3 LEG

NOTES:

- FOR STRETCHER SIZE 26.25, 30.25, 33.75IN, 16IN FOOT IS USED.
 004839D - FOOT W/ ENDCAPS ASSY, 16
 FOR OTHER STRETCHER SIZES 19IN FOOT IS USED.
 004838D - FOOT W/ ENDCAPS ASSY, 19.
 ITEM#3, 15.25IN FOOT WILL ALWAYS COME IN THE CENTRE.
- THE FOLLOWING 120 DEG LH STRETCHER SIZES CAN BE USED DEPENDING ON THE LENGTH OF THE WORKSURFACE.
 26.25 IN - 004879D
 30.25 IN - 004880D
 33.75 IN - 004881D
 37.75 IN - 004882D
 47 IN - 004883D
 51.50 IN - 004884D
- THE FOLLOWING 120/90 DEG RH STRETCHER SIZES CAN BE USED DEPENDING ON THE LENGTH OF THE WORKSURFACE.
 26.25 IN - 004865D
 30.25 IN - 004866D
 33.75 IN - 004867D
 37.75 IN - 004868D
 47 IN - 004869D
 51.50 IN - 004870D
 60 IN - 005306D
 70 IN - 005307D
 74 IN - 005308D
- ONE OF THE FOLLOWING WORKSURFACE CONTROL KITS CAN BE USED.
 004846D - WORKSURFACE CONTROL KIT - 3 LEG
 003765D - WORKSURFACE (ADJ) CONTROL KIT - 3 LEG
 004999D - WORKSURFACE DIGITAL CONTROL KIT - 3 LEG.

SCALE 0.175